

# 'MS5R' Series Remote MANIFOLD VALVES

MS5R

**6,000 psi [Pn 408] Rated 10,000 psi [Pn 680] Rated**  
**DESIGN FEATURES**

- \* Top Sealing Bonnet style
- \* Robust HIGH pressure design
- \* DESIGNED to be maintained
- \* NON-Rotating tip as standard
- \* Hard TIP for effective shut-off and life
- \* Low operating torque
- \* Smooth 7 turns from OPEN to CLOSE
- \* Back sealing on the stem
- \* 316 ss to NACE Specification
- \* Mounting Holes
- \* Adjustable gland packing
- \* Full material traceability
- \* Stem Seal below actuating threads to prevent contamination & gauling of threads
- \* Metal/Metal bonnet seal for pressure tightness even at elevated temperatures

A 5 Valve Remote Manifold for Isolation and Venting.

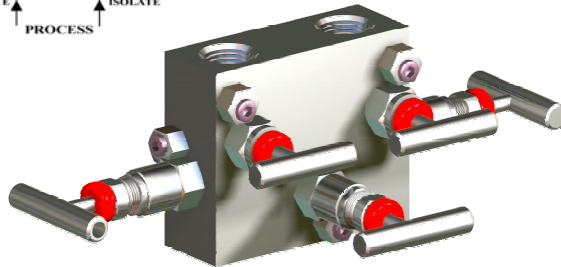
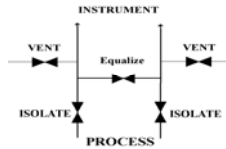

Picture shows Standard Head Unit fitted to Vent Ports.  
 Economy Heads fitted as standard

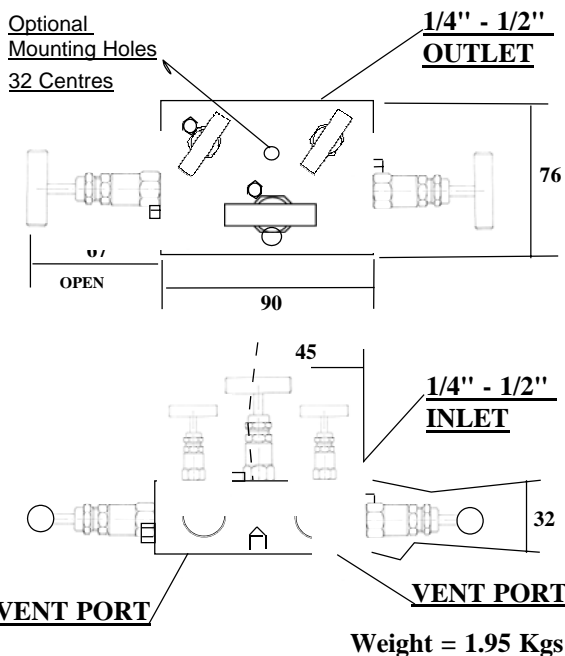

Weight = 1.95 Kgs

Optional bracket mounting holes in base = M8-15 Deep on 32mm centres

ITEM	COMPONENT	MATERIAL
1	BODY	316 S 11 *
2	BONNET HOUSING	316 S 11 *
3	HANDLE	316 S 11
4	STEM	316 S 11
5	STEM TIP	17 / 4 PH
6	GRUB SCREW	STAINLESS STEEL
7	DUST CAP	PVC
8	RETAINING CAM	STAINLESS STEEL
9	RETAINING SCREW	STAINLESS STEEL
10	GLAND ADJUSTER	316 S 11
11	LOCK NUT	316 S 11
12	GLAND PACKING	PTFE / GRAPHOIL
13	BONNET GASKET	316 S 11
14	BONNET SEAL	V PTFE

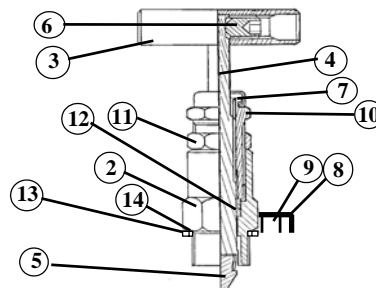

**Sample Part Number MS53RP0515NF0S**

1/2"NPT[F] in 316SS 5 Valve Remote Manifold 5mm Bore, - Rated 6,000psi/Pn 408.

VALVE PART NUMBER and ORDERING TABLE						
Valve Series	Orifice	Size	Threads	Vent	*Material	Options
MS5RP 6,000 psi/Pn408	05	08 - 1/4" 15 - 1/2"	NF - NPT-female PF - BSPP-female TF - BSPT-female	0=No Vent	D - 31803 Duplex SS H - Hasteloy M - Monel S - 316 SS	AT - AnitTamper G - Graphoil HW - Handwheel-316 Tg - Tagging Tf - Soft Tip [PEEK] Tk - Soft Tip [PVDF]
MS5RX 10,000 psi/Pn680						

We reserve the right to change specifications stated in this leaflet due to our continuing programme of development. All valves have 'T' Bar handle as standard.



Website: [www.colson.co.uk](http://www.colson.co.uk)

e-mail: [sales@colson.co.uk](mailto:sales@colson.co.uk)



Certificate No L RQ 0960294  
 ISO 9001 Registered

Park Works, Park Road, ELLAND  
 West Yorkshire. HX5 9HN - England

Tel +44 (0) 845 094 3780  
 Fax +44 (0) 845 094 3790