

DWF 'DWF' Series WAFER Style BALL VALVES

WAFER Style BALL Valves



DESIGN FEATURES

- * Wide choice of Flange sizes and Pressure ratings.
- * Robust HIGH pressure design
- * DESIGNED to be maintained
- * Anti Blow out stem as standard
- * Low operating torque,
- * Floating ball design
- * Smooth turns from OPEN to CLOSE
- * 316 ss to NACE Specification
- * Adjustable gland packing
- * Replaceable seats and seals
- * Locking Kit available
- * Full material traceability
- * Stem Seal below actuating threads to prevent contamination & gauling of threads
- * Can be actuated

MATERIALS of CONSTRUCTION - 316 Stainless Steel

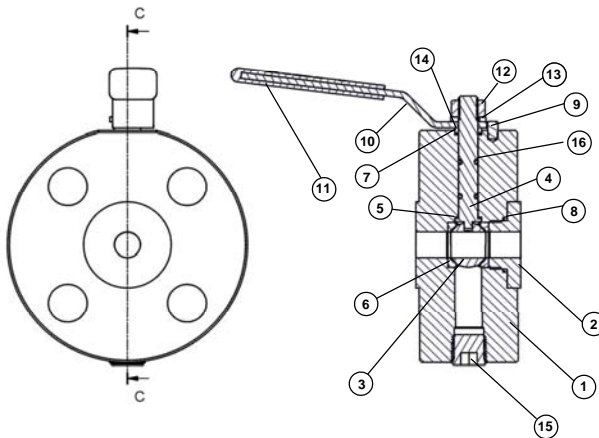

ITEM	COMPONENT	MATERIAL
1	BODY	316 S 11 *
2	INSERT	316 S 11 *
3	BALL	316 S 11 *
4	STEM	316 S 11 *
5	STEM SEAL	RTFE
6	SEATS	PTFE / PVDF
7	TOP SEAL	RTFE
8	BODY SEAL	PTFE
9	PIN	STAINLESS STEEL
10	LEVER HANDLE	STAINLESS STEEL
11	HANDLE SLEEVE	PVC
12	NUT	A4 ss
13	WASHER	A4 ss
14	SPACER	316 SS
15	BODY PLUG	316 SS *
16	STEM SEAL	VITON

Part No. DWFABF1025CB0S

1"600lb Serrated Face Flanged WaferBlock Ball Valve
with PVDE Seats, RTFE Seals in 316ss

VALVE PART NUMBER and ORDERING TABLE								
Series - Style	PRESSURE	BORE	Inlet/Outlet Flange Size/Type/Finish		Vent	* Material	Options	
DWFA	B=BALL	F=Flange Rating	10	15	A=C150 B=C300 C=C600 D=C800 E=C900 F=C1500 G=C2500	A= Smooth B= Serrated C=RTJ	0=No VENT	A - Ali-Bronze C - C/Steel D - Duplex SS H - Hasteloy I - Incoloy M - Monel S - 316 SS X - SPECIAL
			13	20				
			19	25				
			25	32				
			32	40				
			38	46				
			50	50				
			54	65			Tg Tagging	

We reserve the right to change specifications stated in this leaflet due to our continuing programme of development. DWFB - 01/05
All valves have 316ss Lever Handle as standard. Do not repeat the OUTLET PART NUMBER as is same as INLET

Colson
Industries Ltd

Website: www.colson.co.uk

e-mail: sales@colson.co.uk Certificate No LRQ 0960294
ISO 9001 Registered



Park Works, Park Road, ELLAND
West Yorkshire. HX5 9HN - England

Tel +44 (0) 845 094 3780
Fax +44 (0) 845 094 3790