

'DMB' Series Block & Bleed VALVES

Modular Block & Bleed Ball Valves, Needle Valve

DESIGN FEATURES

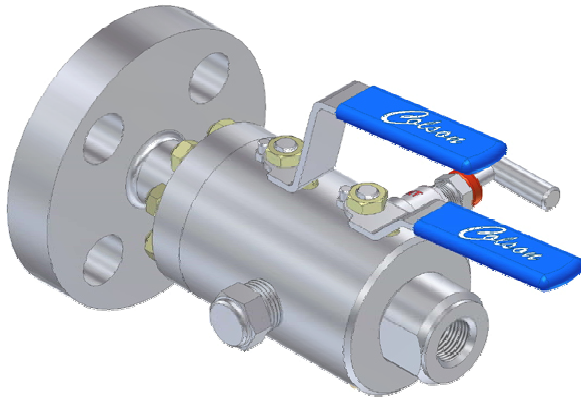

**Fire Tested Design
to BS 6755 Pt 2**

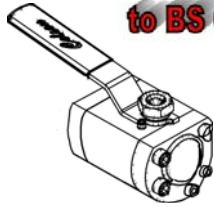

DMBAB
Block -
Ball Style

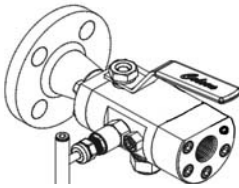

DMBBE
Block & Bleed -
Ball/Needle Style

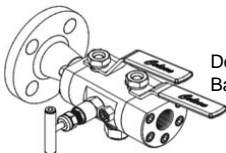

DMBCM
Double Block & Bleed -
Ball/Needle/Ball Style

ISOLATE VALVE :-

- * Firesafe tested Design to BS 6755 Pt 2
- * Top Sealing Bonnet style
- * Wide choice of Flange Rating & Threaded ends.
- * Robust HIGH pressure DESIGNED to be maintained
- * Ball Valve has anti blowout stem for safety
- * Floating ball design for positive shut-off
- * Replaceable seats & seals for extended life

VENT VALVE :-

- * NON-Rotating hard tip on bleed valve for effective shut-off
- * Back sealing on the stem & adjustable gland packing
- * Stem Seal below actuating threads to prevent contamination & gauling of threads
- * Metal/Metal bonnet seal for pressure tightness even at elevated temperatures

- * Choice of Block, Block & Bleed or Double Block& Bleed
- * Bleed Port with socket pressure plug or Tube fitting
- * 316 ss to NACE Specification & Full material traceability

DMBAB BALL VALVE AS-

ITEM	COMPONENT	MATERIAL
1	BODY	316 S 11
2	BONNET HOUSING	316 S 11
3	END FLANGE	316 S 11
4	BALL	316 S 11
5	STEM	316 S 11
6	STEM SEAL	PTFE/GRAPHOIL
7	SEATS	PTFE / PVDF/PEEK
8	TOP SEAL	RTFE/GRAPHO
9	END FLANGE SEAL	PTFE/GRAPHOIL
10	PIN	STAINLESS STEEL
11	LEVER HANDLE	STAINLESS STEEL
12	HANDLE SLEEVE	PVC
13	NUT	A4 ss
14	WASHER	A4 ss
15	SPACER	316 SS

SNV HEAD ASSY

ITEM	COMPONENT	MATERIAL
1	BODY	316 S 11
2	BONNET HOUSING	316 S 11
3	HANDLE	316 S 11
4	STEM	316 S 11
5	STEM TIP	17 / 4 PH
6	GRUB SCREW	STAINLESS STEEL
7	DUST CAP	PVC
8	RETAINING CAM	STAINLESS STEEL
9	RETAINING SCREW	STAINLESS STEEL
10	GLAND ADJUSTER	316 S 11
11	LOCK NUT	316 S 11
12	GLAND PACKING	RTFE / GRAPHOIL
13	BONNET GASKET	316 S 11
14	BONNET SEAL	V PTFE

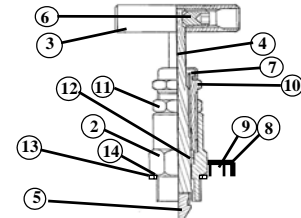
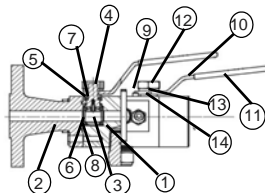

Part No. DMBCM F1925CB15NF1S

1"600lb Serrated Face Flanged Double Block & Bleed Valve [Ball/Needle/Ball Configuration] with PTFE/17-4PH Trim. 1/2"NPT Outlet/1/4"NPT Vent in316ss

VALVE PART NUMBER and ORDERING TABLE									
Series - Style	PRESSURE	BORE	Inlet Size/Type/Finish		Outlet Size/Type/Finish		Vent	* Material	Options
DMBA	B=Ball F=Flange Rating	06	08	A=C150	A= Smooth	08	A=C150	A= Ali-Bronze	-Tg Tagging
		10	10	B=C300	B= Smooth	10	B=C300	C - C/Steel	-H Handwheel
		13	15	C=C600	B= Serrated	15	C=C600	D - Duplex SS	-LK Locking Kit
DMBB	E=B/N F=B/B	19	20	D=C800	C=RTJ	20	D=C800	H - Hasteloy	-AT AntiTamper Head Unit
		25	25	E=C900	H=HUB	25	E=C900	I - Incoloy	
		32	32	F=C1500		32	F=C1500	M - Monel	-ATK A/T Key
DMBC	G=B/B/B K=B/N/N M=B/N	40	46	NF=NPT(F)		46	NF=NPT(F)	S - 316 SS	-HW Handwheel 316 SS
		50	50	NM=NPT(M)		50	NM=NPT(M)	X - SPECIAL	
		54	54	PF=BSPP(F) PM=BSPP(M)		54	PF=BSPP(F) PM=BSPP(M)		-Tg Tagging

We reserve the right to change specifications stated in this leaflet due to our continuing programme of development. All Ball valves have lever handle as standard. Anti-Tamper Keys are always supplied separately, for security. Ball & stem materials will be the same as the body material except for C/Steel which has 316 trim. It is always recommended that the valve is supported and not left to carry the weight of the pipework as damage may occur.

DMB - 02/04

Note- Do not repeat part number for Outlet if same as INLET



Website: www.colson.co.uk

e-mail: sales@colson.co.uk



Certificate No LKQ 0960294
ISO 9001 Registered

Park Works, Park Road,
ELLAND, West Yorkshire.
HX5 9HN - England

Tel +44 (0) 845 094 3780
Fax +44 (0) 845 094 3790