

MS3D 'MS3D' Series Direct MANIFOLD Valves

6,000 psi [Pn 408] Rated 10,000 psi [Pn 680] Rated

A Compact bodied 3 Valve Direct Manifold for Isolation and an angled Equalization head for ease of use

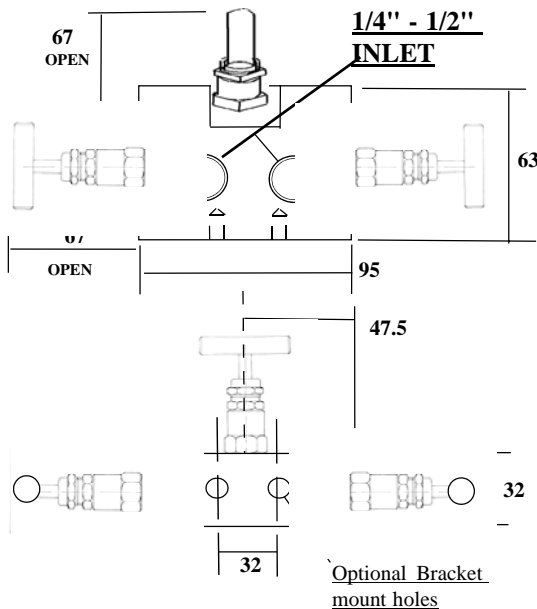
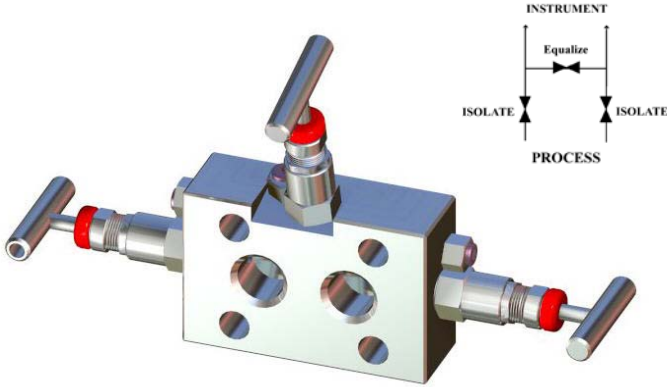

Instrument Mounting holes are 54mm centres **Weight = 1.45 Kgs**
Optional Bracket mounting holes in base are M8 - 15 Deep/32mm centres

DESIGN FEATURES

- * Top Sealing Bonnet style
- * Robust HIGH pressure design
- * DESIGNED to be maintained
- * NON-Rotating tip as standard
- * Hard TIP for effective shut-off and life
- * Low operating torque
- * Smooth 7 turns from OPEN to CLOSE
- * Back sealing on the stem
- * 316 ss to NACE Specification
- * Angled Head for ease of use
- * Instrument mounting holes @ 54mm
- * Adjustable gland packing
- * Compact body design
- * Full material traceability
- * Stem Seal below actuating threads to prevent contamination & gauling of threads
- * Metal/Metal bonnet seal for pressure tightness even at elevated temperatures
- * Choice of Economy [NE-6K Only] or Standard Head [NS] or LOW TORK Head [NL]

ITEM	COMPONENT	MATERIAL
1	BODY	316 S 11 *
2	BONNET HOUSING	316 S 11 *
3	HANDLE	316 S 11
4	STEM	316 S 11
5	STEM TIP	17 / 4 PH
6	GRUB SCREW	STAINLESS STEEL
7	DUST CAP	PVC
8	RETAINING CAM	STAINLESS STEEL
9	RETAINING SCREW	STAINLESS STEEL
10	GLAND ADJUSTER	316 S 11
11	LOCK NUT	316 S 11
12	GLAND PACKING	PTFE / GRAPHOIL
13	BONNET GASKET	316 S 11
14	BONNET SEAL	V PTFE

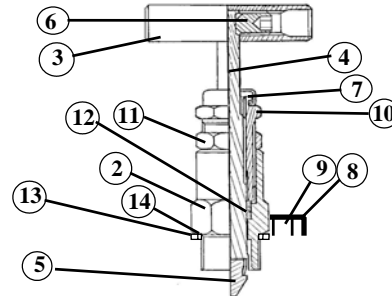

Sample Part Number MS3DP0515NF0S

1/2"NPT[F] in 316SS 3 Valve Direct Manifold 5mm Bore, - Rated 6,000psi/Pn 408.

VALVE PART NUMBER and ORDERING TABLE

Valve Series	Orifice	Size	Threads	Vent	*Material	Options
MS3DP 6,000 psi/Pn408	05	08 - 1/4" 15 - 1/2"	NF - NPT-female PF - BSPP-female TF - BSPT-female	0=No Vent	D - 31803 Duplex SS H - Hasteloy M - Monel S - 316 SS	G - Graphoil HW - Handwheel-316 Tg - Tagging Tf - Soft Tip [PEEK] Tk - Soft Tip [PVDF]
MS3DX 10,000 psi/Pn680						

We reserve the right to change specifications stated in this leaflet due to our continuing programme of development. All valves have 'T' Bar handle as standard.

MS3D -01/08

Colson
Industries Ltd

Website: www.colson.co.uk

e-mail: sales@colson.co.uk



Certificate No L RQ 0960294
ISO 9001 Registered

Park Works, Park Road, ELLAND
West Yorkshire. HX5 9HN - England

Tel +44 (0) 845 094 3780
Fax +44 (0) 845 094 3790